

TOP

REDUCE FROM 10 AWG ($\varnothing.201$)
TO FIT HOLE IN BODY

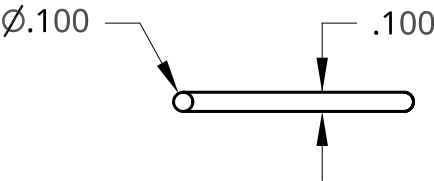

THIS CIRCULAR EDGE
MAY BE BROKEN

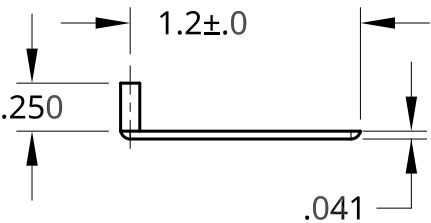
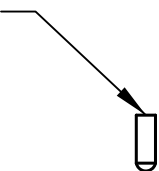

CHAMFER ENDS AS DESIRED

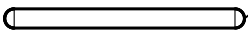

THE NICK WIRE IS A 10 AWG ($\varnothing.102$) WIRE
CUT TO JUST UNDER HALF THICKNESS.

THIS MAY BE MADE AS A SINGLE PIECE
BY COLD FORGING A SQUARE BEND IN
A 10 AWG WIRE. ALTERNATIVELY, IT
MAY BE MADE IN TWO PIECES WHICH
ARE SILVER-BRAZED TOGETHER.

DO NOT BREAK ANY EDGES
UNLESS NOTED

UNLESS OTHERWISE SPECIFIED, DIMENSIONS ARE IN INCHES		NAME	DATE	CircuitousRoot		
	DRAWN	DMM	2019-08-01	TITLE HMB - HAND MOLD B 4HMB1 NICK WIRE		
	CHECKED					
	APPROVED					
DO NOT SCALE DRAWING						
THIRD ANGLE PROJECTION	MATERIAL	FINISH		SIZE	DWG NO.	REV.
	STEEL			A		0
				SCALE	WEIGHT	SHEET
				1:1		1 of 1